

# 88' FOLGORE

#33

*Riva*



**PETREL GLOBAL SHIPS  
& BOATS TRADING LLC** Office 621, 6th Floor Block A, Business Village.  
Port-Saeed Deira, Dubai UAE  
www.petrel-global.com., tel.: +971 52 821 6411

# RIVA 88' FOLGORE



## TECHNICAL SPECIFICATIONS

Status: Ready for shipping, Italy, La Spezia

Length..... 26.84 m

Width..... 6.29 m

Draft ..... 1.82 m

Fuel capacity ..... 7,500 l

Water capacity..... 990 l

Number of guests ..... 8

Engine ..... 2 x MTU 16V 2000

Maximum speed..... 40.5 knots

Cruising speed ..... 35 knots

Range ..... 330 nm

Weight..... 63,000 kg

Hull color ..... Metallic Regal Silver

Deck material..... Natural Teak

# RIVA 88' FOLGORE



*Riva*



**PETREL GLOBAL SHIPS  
& BOATS TRADING LLC** Office 621, 6th Floor Block A, Business Village.  
Port-Saeed Deira, Dubai UAE  
www.petrel-global.com., tel.: +971 52 821 6411

# RIVA 88' FOLGORE



*Riva*



**PETREL GLOBAL SHIPS  
& BOATS TRADING LLC** Office 621, 6th Floor Block A, Business Village,  
Port-Saeed Deira, Dubai UAE  
www.petrel-global.com., tel.: +971 52 821 6411

# RIVA 88' FOLGORE

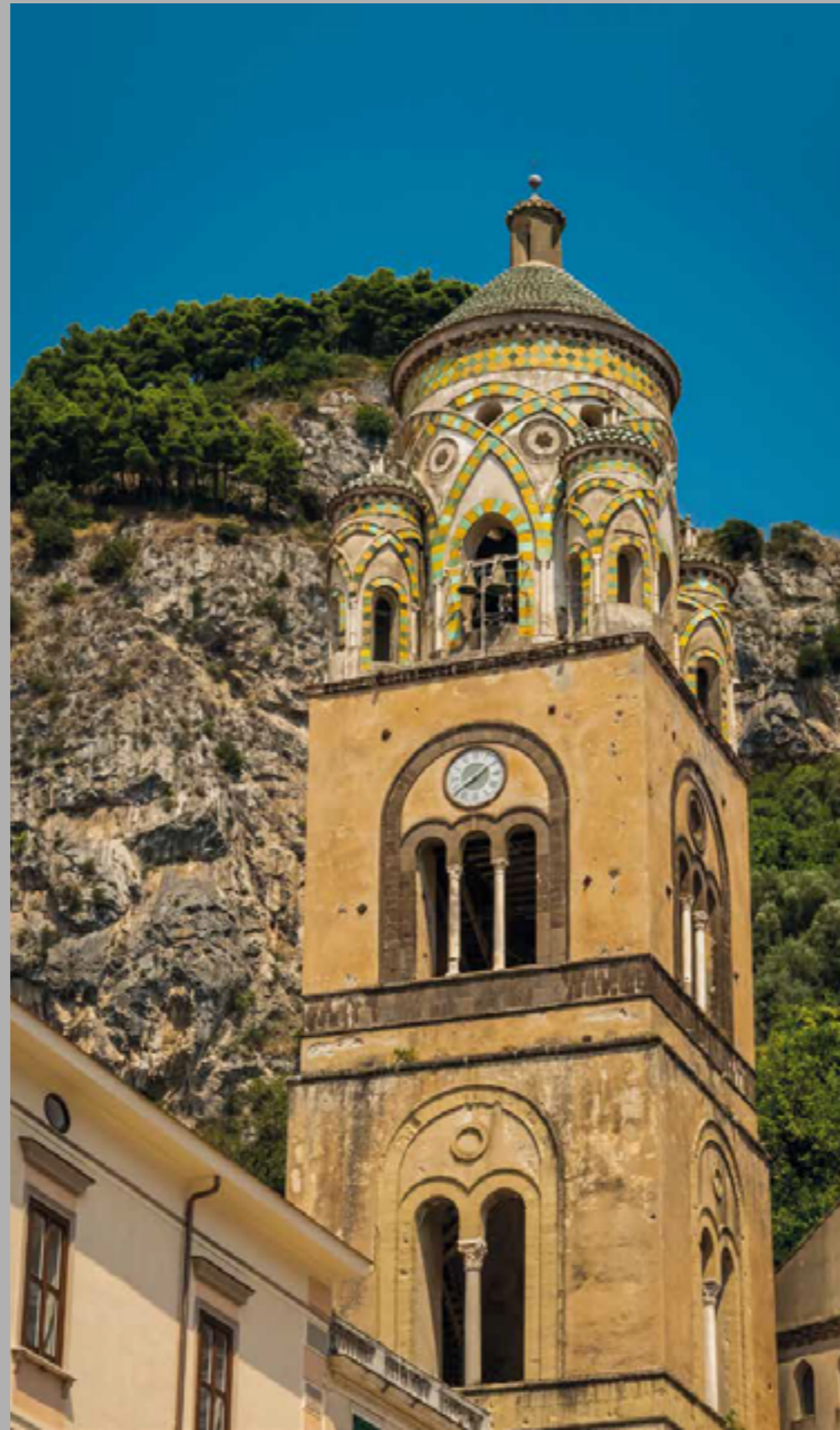

Riva



**PETREL GLOBAL SHIPS  
& BOATS TRADING LLC** Office 621, 6th Floor Block A, Business Village.  
Port-Saeed Deira, Dubai UAE  
www.petrel-global.com., tel.: +971 52 821 6411

# RIVA 88' FOLGORE



*Riva*



**PETREL GLOBAL SHIPS  
& BOATS TRADING LLC** Office 621, 6th Floor Block A, Business Village.  
Port-Saeed Deira, Dubai UAE  
www.petrel-global.com., tel.: +971 52 821 6411

# RIVA 88' FOLGORE



*Riva*



**PETREL GLOBAL SHIPS  
& BOATS TRADING LLC** Office 621, 6th Floor Block A, Business Village.  
Port-Saeed Deira, Dubai UAE  
www.petrel-global.com., tel.: +971 52 821 6411

# RIVA 88' FOLGORE



*Riva*



**PETREL GLOBAL SHIPS  
& BOATS TRADING LLC** Office 621, 6th Floor Block A, Business Village,  
Port-Saeed Deira, Dubai UAE  
www.petrel-global.com., tel.: +971 52 821 6411

# RIVA 88' FOLGORE



*Riva*



**PETREL GLOBAL SHIPS  
& BOATS TRADING LLC** Office 621, 6th Floor Block A, Business Village.  
Port-Saeed Deira, Dubai UAE  
www.petrel-global.com., tel.: +971 52 821 6411

# RIVA 88' FOLGORE



*Riva*



**PETREL GLOBAL SHIPS  
& BOATS TRADING LLC** Office 621, 6th Floor Block A, Business Village.  
Port-Saeed Deira, Dubai UAE  
www.petrel-global.com., tel.: +971 52 821 6411

# RIVA 88' FOLGORE



Riva



**PETREL GLOBAL SHIPS  
& BOATS TRADING LLC** Office 621, 6th Floor Block A, Business Village.  
Port-Saeed Deira, Dubai UAE  
www.petrel-global.com., tel.: +971 52 821 6411

# RIVA 88' FOLGORE



*Riva*



**PETREL GLOBAL SHIPS  
& BOATS TRADING LLC** Office 621, 6th Floor Block A, Business Village.  
Port-Saeed Deira, Dubai UAE  
www.petrel-global.com., tel.: +971 52 821 6411

# RIVA 88' FOLGORE



*Riva*



**PETREL GLOBAL SHIPS  
& BOATS TRADING LLC** Office 621, 6th Floor Block A, Business Village.  
Port-Saeed Deira, Dubai UAE  
www.petrel-global.com., tel.: +971 52 821 6411

# RIVA 88' FOLGORE



*Riva*



**PETREL GLOBAL SHIPS  
& BOATS TRADING LLC** Office 621, 6th Floor Block A, Business Village.  
Port-Saeed Deira, Dubai UAE  
www.petrel-global.com., tel.: +971 52 821 6411

# RIVA 88' FOLGORE



Riva



**PETREL GLOBAL SHIPS  
& BOATS TRADING LLC** Office 621, 6th Floor Block A, Business Village.  
Port-Saeed Deira, Dubai UAE  
www.petrel-global.com., tel.: +971 52 821 6411

# RIVA 88' FOLGORE



*Riva*



**PETREL GLOBAL SHIPS  
& BOATS TRADING LLC** Office 621, 6th Floor Block A, Business Village.  
Port-Saeed Deira, Dubai UAE  
www.petrel-global.com., tel.: +971 52 821 6411

# RIVA 88' FOLGORE



*Riva*



**PETREL GLOBAL SHIPS  
& BOATS TRADING LLC** Office 621, 6th Floor Block A, Business Village.  
Port-Saeed Deira, Dubai UAE  
www.petrel-global.com., tel.: +971 52 821 6411

# RIVA 88' FOLGORE



Riva



**PETREL GLOBAL SHIPS  
& BOATS TRADING LLC** Office 621, 6th Floor Block A, Business Village.  
Port-Saeed Deira, Dubai UAE  
www.petrel-global.com., tel.: +971 52 821 6411

# RIVA 88' FOLGORE



*Riva*



**PETREL GLOBAL SHIPS  
& BOATS TRADING LLC** Office 621, 6th Floor Block A, Business Village.  
Port-Saeed Deira, Dubai UAE  
www.petrel-global.com., tel.: +971 52 821 6411

# RIVA 88' FOLGORE



# RIVA 88' FOLGORE

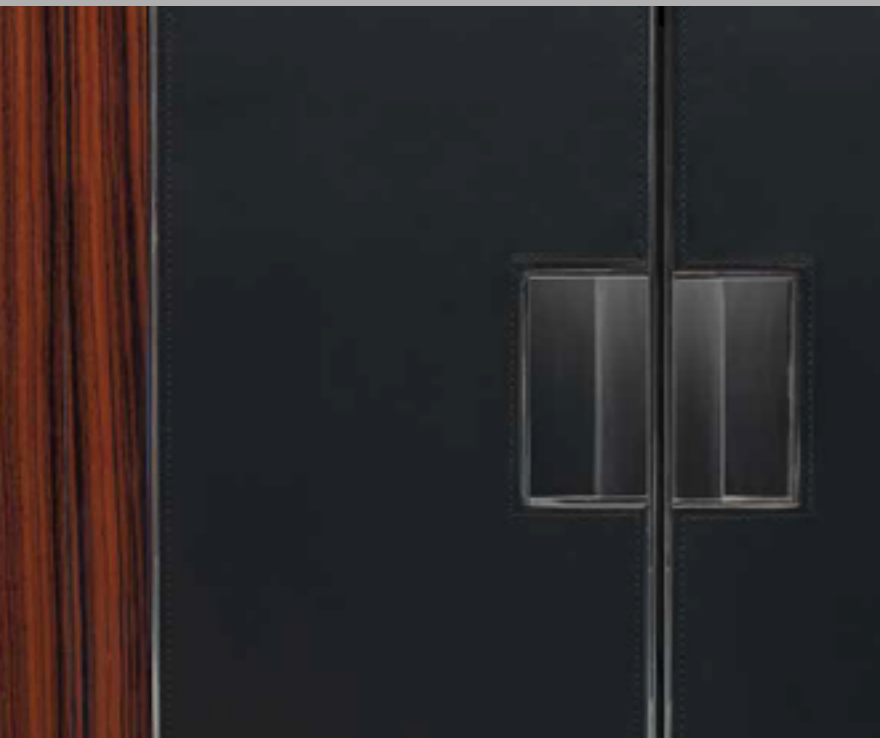

# RIVA 88' FOLGORE



# RIVA 88' FOLGORE



Riva



**PETREL GLOBAL SHIPS  
& BOATS TRADING LLC**

Office 621, 6th Floor Block A, Business Village,  
Port-Saeed Deira, Dubai UAE  
www.petrel-global.com., tel.: +971 52 821 6411

# RIVA 88' FOLGORE



Riva



**PETREL GLOBAL SHIPS  
& BOATS TRADING LLC** Office 621, 6th Floor Block A, Business Village.  
Port-Saeed Deira, Dubai UAE  
www.petrel-global.com., tel.: +971 52 821 6411

# RIVA 88' FOLGORE



Riva



**PETREL GLOBAL SHIPS  
& BOATS TRADING LLC** Office 621, 6th Floor Block A, Business Village.  
Port-Saeed Deira, Dubai UAE  
www.petrel-global.com., tel.: +971 52 821 6411

# RIVA 88' FOLGORE



*Riva*



**PETREL GLOBAL SHIPS  
& BOATS TRADING LLC** Office 621, 6th Floor Block A, Business Village,  
Port-Saeed Deira, Dubai UAE  
www.petrel-global.com., tel.: +971 52 821 6411

# RIVA 88' FOLGORE

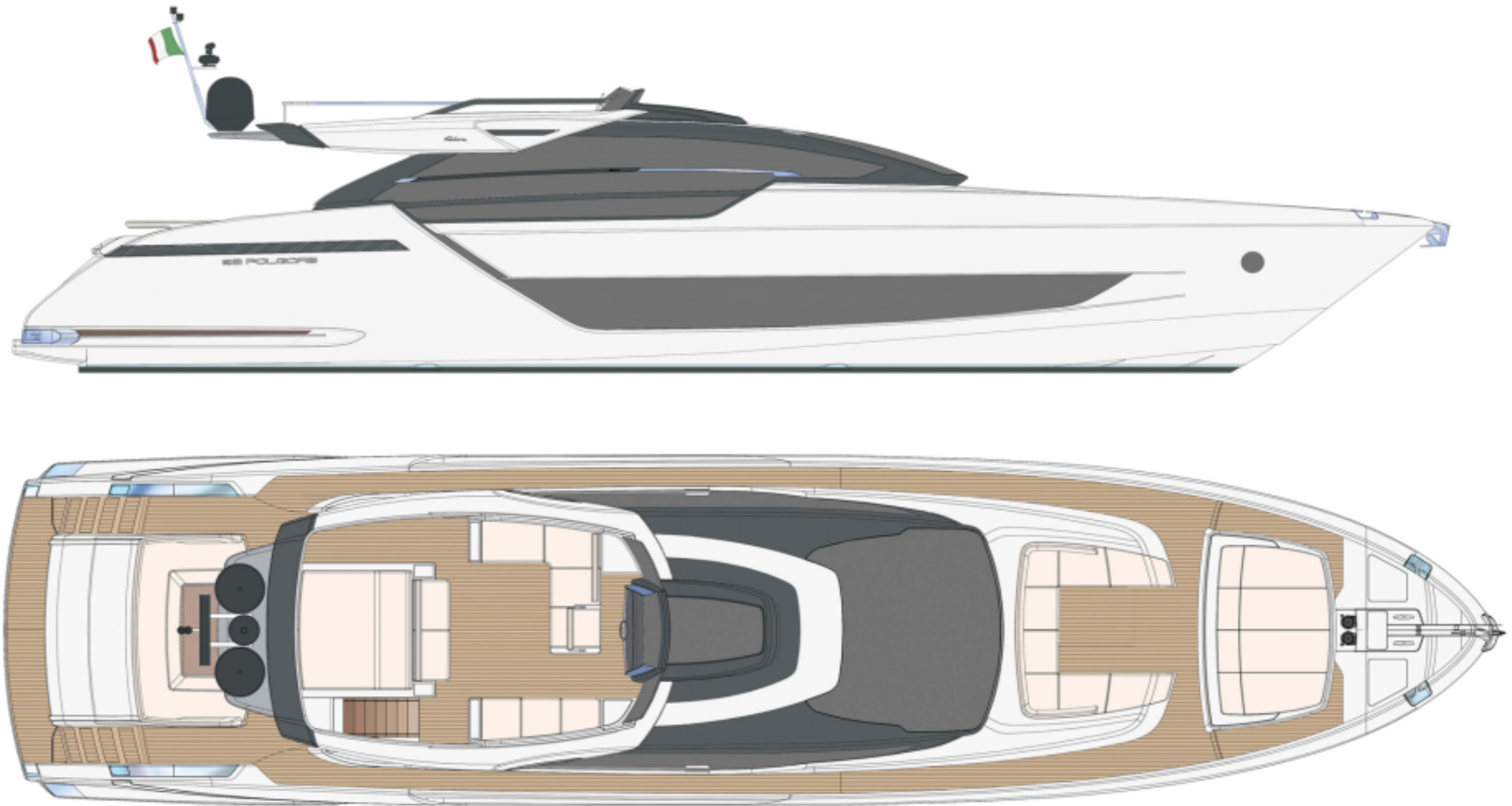

# RIVA 88' FOLGORE

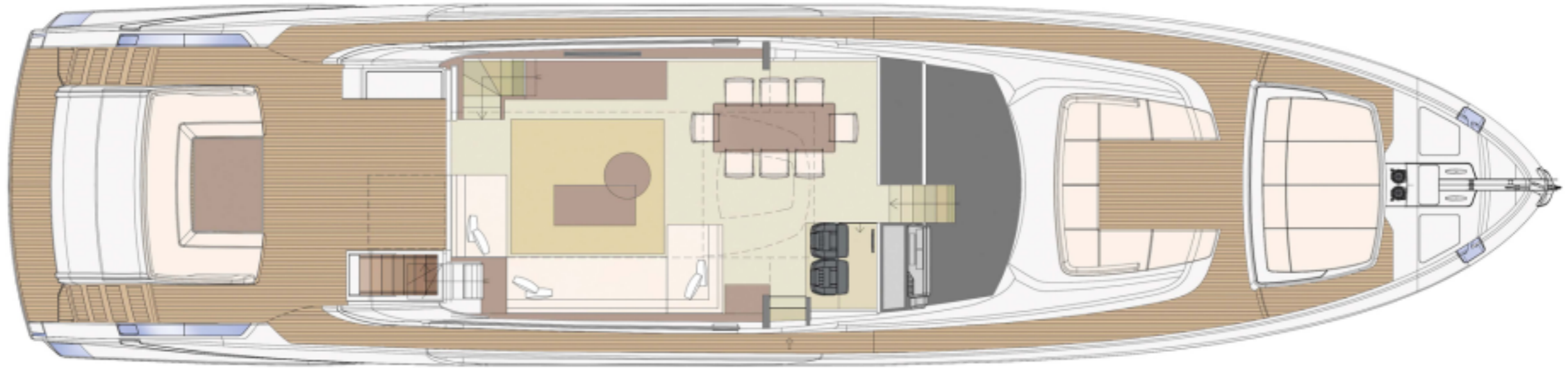

## ADDITIONAL OPTIONS

- ENGINES 2 x MTU 2638hp EPA Tier III compliant - diff.
- TIMBER: Brushed Alpi Light Grey Oak 10gloss Matt diff. from standard Sand Oak
- MASTER CABIN: CUSTOM LAYOUT «A» with starboard side double bed and portside armchair and coffee table
- MASTER CABIN: (portside) bigger size wardrobe and porthole displacement towards stern
- HULL, DECK AND AFT: Riva's painted colour (SHARK GREY)
- SUPERSTRUCTURE: Riva's painted colour (SHARK GREY)
- 27 kW GENERATOR UPGRADE - diff. than 19 kW
- 27 kW AUXILIARY GENERATOR - diff. than 7 kW
- Generator battery chargers (2)
- Super tropical air conditioning system
- Gyroscopic stabilizer
- COCKPIT: bar furniture with electric top, sink and fridge (painted GRP structure and front part)
- Standard ice-maker to be installed in the bar furniture
- Optional fridge to be installed in portside cabinet
- MAIN DECK SALON: skylight in forward ceiling
- PORTSIDE GUEST CABIN: manual sliding bed to convert the twin beds into a double bed
- AFT AREA: 100 Gloss Mahogany wood for stern portside & starboard rub rail
- COCKPIT: 100 Gloss Mahogany details for aft sofa
- COCKPIT: additional door in glass and stainless steel for hatch between cockpit and sundeck
- Electric Glendinning for 100A shore power connection
- GALLEY: 90cm appliances (oven, cook top and extraction hood) - diff. from 60cm
- SALON: fore portside furniture modification to create storage compartments
- GUEST CABINS (2): extra storage (additional top cabinets)
- MASTER CABIN AND VIP CABIN: extra storage (custom storage bed)
- MAIN DECK CABINETS: leather top upholstery
- LOWER DECK CABINETS: cabinet doors' leather upholstery with stitching
- USB type A+C outlets (13 pcs: 2 in each cabin + 2 in salon + 1 in bridge + 2 in crew area)
- Launch system for tender Williams 395 Sportjet (tender not included)
- Launch system for jet ski SEA DOO GTR 230 (jet ski not included)
- Underwater lights on transom (2) - white colour
- Side underwater lights on side (5 each side) - white colour
- COCKPIT: third control station complete with multidata and bow & stern thruster control
- Hydraulic stern thruster
- DINING AREA: wine cellar
- COCKPIT: electric hi-low table (designed with foldable 100 gloss Mahogany top)
- LOWER DECK CABINS: additional stainless steel finish & details for wardrobe doors
- FOREDECK: preparation for both fixed and electric hi/low table
- Centralized system for oil change (engines, inverters and generators)
- Water maker 180l/h with remote control
- Weather station
- Pre-wiring (electric cables) for future installation of 1x Starlink System/antenna
- Premium Sound for external areas with top quality loudspeakers and automatic independent airplay in foredeck, cockpit and flybridge (JL brand)
- MAIN BRIDGE: 3x display upgrade from 16" to 19"
- SUNDECK: 2x display upgrade from 12" to 16"
- Helm station: Joystick Dual Station
- Helm station: Joystick Dynamic Positioning SYS (Light)
- SALON: TV upgrade to 55» - diff.
- MASTER CABIN: TV upgrade to 55» - diff.
- VIP Cabin: TV upgrade to 43» - diff.
- PORTSIDE GUEST CABIN: 50" TV with audio&video upgrade
- STARBOARD GUEST CABIN: 24» TV with stainless steel totem
- Simrad display 16" in crew dinette
- Flir thermal night vision video camera
- AIS system (A class)
- TV 24" with mini Hi-Fi in crew dinette
- MAIN DECK BRIDGE: electric hi-low pilot seat
- MASTER CABIN: Premium Sound
- Premium Internet Package (5G single active SIM) – Single active SIM + back-up and antennas.
- Domotic "A" package in salon and Master cabin (one remote control with iPad interface to manage audio-video, lights, curtains and air condition)
- Anti-collision System Watchit
- COCKPIT: GRP preparation for manual awning
- FOREDECK: GRP preparation for manual awning
- SUNDECK: GRP preparation for manual awning
- FOREDECK: electro-hydraulic concealed bimini top for upper part of the sunpad area
- Active carbon fiber
- UV Water sterilizer
- Water softener
- GALLEY: bigger sink than standard
- AMBIENT LIGHTS in main deck and lower deck (excluding galley, crew areas and heads)
- AMBIENT LIGHTS in bathrooms
- Additional aft cleats (2) for tender's mooring
- CREW DINETTE: washing machine and dryer (two separate appliances)
- DIMMER SWITCH for internal and external lights (not included: crew areas, equipment areas, navigation lights, service lights, courtesy lights, bathrooms and galley)
- SUNDECK: drawer fridge (35l)
- ELECTRIC CURTAINS in main deck and lower deck (not included: black-out blinds, wheelhouse, galley, salon aft door, crew quarter and bathrooms)
- ELECTRIC BLACK OUT BLINDS in all cabins (not included: galley, crew quarter and bathrooms)
- Stainless steel protection for side cleats
- SUNDECK: aft manual awning completion with carbon fiber poles (6) and canopy (2)

## ADDITIONAL OPTIONS

- FOREDECK: manual awning completion with carbon fiber poles (4) and canopy (1) for the sofa
- COCKPIT: manual awning completion with carbon fiber poles (2) and canopy (1) for aft sofa
- EXTERNAL UPHOLSTERY: Mambo fabric Pearl White diff. from Italvipla Tropical col.6010 White
- BOAT NAME: backlit cabling pre-wiring
- ALL BATHROOMS (Master, VIP and Guests): Arabescato Vagli marble diff. from standard Corian
- MASTER CABIN: entrance steps in Arabescato Vagli marble diff. from standard carpet Eros
- SOLE LEATHER UPHOLSTERY: Sole leather col. Cognac «Bruciato» C25 diff. from C22 Caramel
- SOLE LEATHER UPHOLSTERY: Sole leather col. White C10 diff. from C22 Caramel (no charge)
- MAIN DECK FLOOR: wooden floor Luxurywood Frassino Canova white brushed striped diff. from standard carpet Eros
- SALON SOFA: Mondrian by Poliform upholsterd with Poliform Komi fabric diff. from Kushiro standard fabric
- DINING TABLE: Custom made by Riva with Blue Antique Marble top with wooden frame (option) diff. from standard table with stainless steel base and crystal top
- DINING CHAIRS: N.8 Velis by Potocco leather upholstered diff. from standard fabric upholstery
- LOWER DECK CARPET: SUPERTUFT AIR carpet diff. from standard Eros carpet
- MASTER ARMCHAIR: Kaori by Poliform diff. from Russell armchair
- MASTER COFFEE TABLE: Alisee coffee table by Molteni diff. from Frank table by B&B Italia (to be quoted)
- Foredeck dinette: electric hi-low table (stainless steel and 100 gloss Mahogany wood top) completion (to be studied & quoted)
- External cushions with piping (on seats; free standing, pilot seat and co-pilot seat on sundeck not included) (to be quoted)
- Mosquito net kit for portholes
- Boat name (stainless steel letters) (to be quoted)
- Port of registry (stainless steel letters) (to be quoted)
- Export documents extra EU

# RIVA 88' FOLGORE



*Riva*



**PETREL GLOBAL SHIPS  
& BOATS TRADING LLC** Office 621, 6th Floor Block A, Business Village.  
Port-Saeed Deira, Dubai UAE  
www.petrel-global.com., tel.: +971 52 821 6411